

705 TWINFLOWER LN  
LOT 1693

 SAUSSY BURBANK



OPTIONAL UPGRADES MAY BE SHOWN ON ARTIST'S RENDERING. SEE  
AGENT FOR DETAILS.

Please Note: Images shown will appear differently across various screens, and when  
installed in your home with different lighting conditions.

COOPER-OW

# EXTERIOR SELECTIONS

1. SIDING - GOSSAMER VEIL (SW9165)
2. TRIM- CHARLESTON WHITE (DCR100)
3. FRONT DOOR - DOESKIN (SW6044)
4. FOUNDATION - PERFECT GREIGE (SW6073)
5. ROOF- MOIRE BLACK

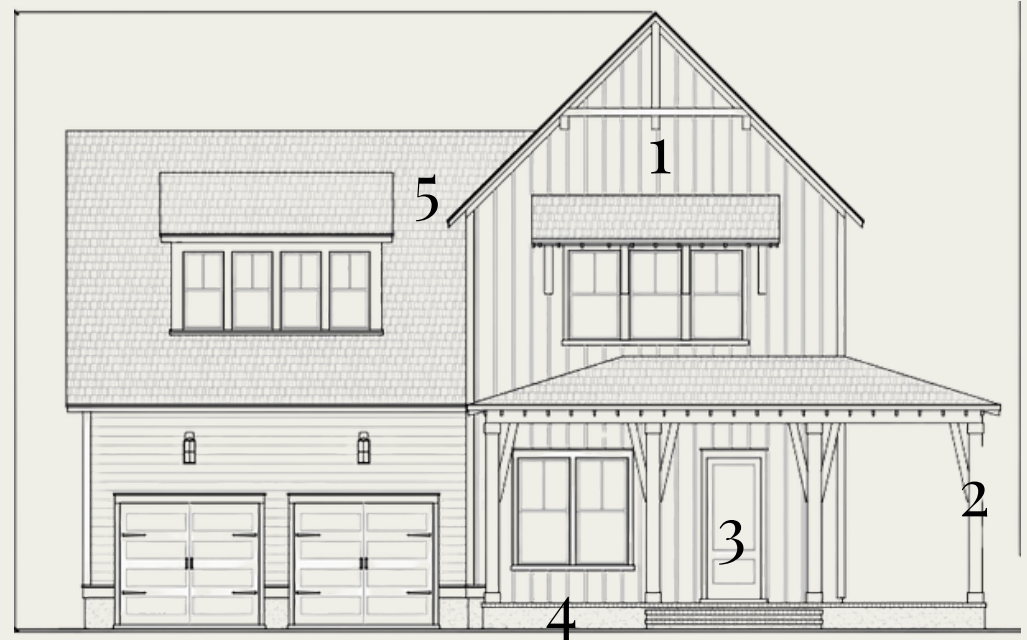
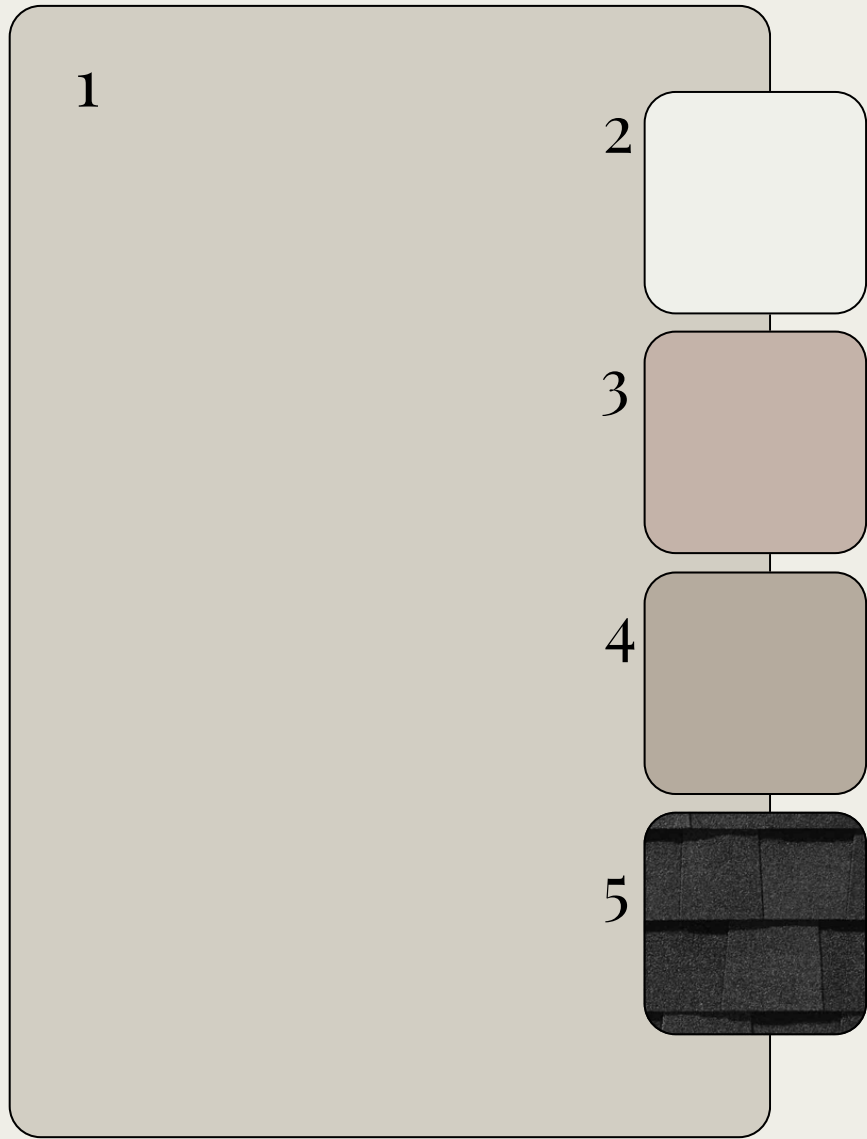

COLORS MAY APPEAR DIFFERENTLY ON SCREENS OR PRINTED

# EXTERIOR HARDWARE & LIGHTING

1



2



3



4



1. FRONT DOOR HARDWARE - SUTTON - MATTE BLACK
2. INTERIOR DOOR HARDWARE - STRATUS KNOB - MATTE BLACK
3. FRONT PORCHES, REAR PORCH & GARAGE ENTRY DOOR - VADO WALL MOUNT LANTERN - BLACK
4. GARAGE DOORS LIGHT - SEBRING WALL LANTERN - BLACK

# INTERIOR SELECTIONS

1

2

1. WALL PAINT - SNOWBOUND  
SW7004
2. TRIM PAINT - PURE WHITE  
SW7005
3. FLOORING - LVP - MOHAWK -  
BENSON PEAK - COVINGTON  
(1ST FLOOR LIVING AREAS, PRIMARY  
BEDROOM, LOFT)
4. FLOORING - CARPET - MOHAWK -  
GLAMOUR HAVEN I - DUSKY  
WILLOW  
(BEDROOMS 2, 3 & 4)

3

4



COLORS MAY APPEAR DIFFERENTLY ON SCREENS OR PRINTED, AND WHEN INSTALLED IN  
DIFFERENT LIGHTING

# INTERIOR LIGHTING

1

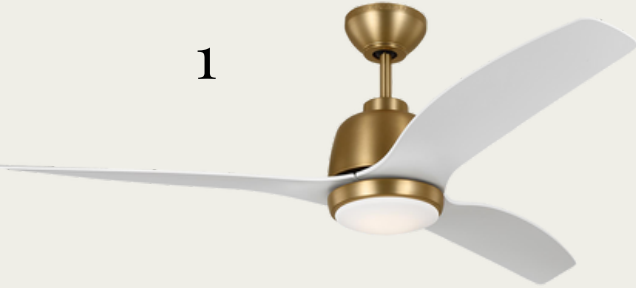

2

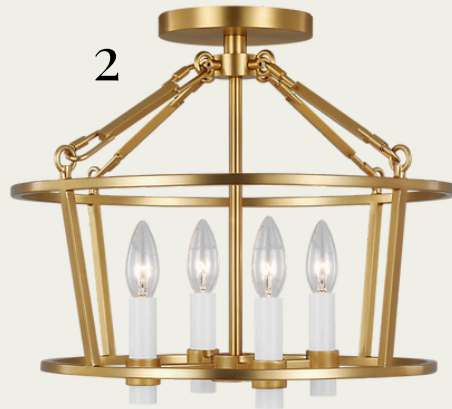

1. FAMILY ROOM/PRIMARY BEDROOM - AVILA 54" LED - WHITE/SATIN BRASS
2. FOYER - MARSTON SEMI-FLUSH - BURNISHED BRASS
3. DINING ROOM - THURLO LARGE HANGING SHADE
4. BED 2 & 3 - LARSON MEDIUM FLUSH MOUNT
5. LOFT & BED 4 - JOVIE 52" LED - WHITE
6. STUDY - PERNO MEDIUM SEMI-FLUSH - BURNISHED BRASS

3



4

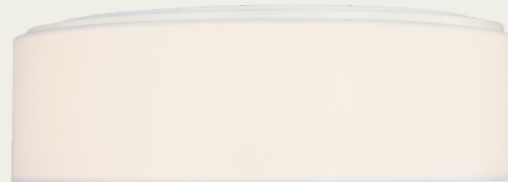

6



5



# KITCHEN



1. FAUCET- DELTA MONROVIA
2. DISPOSAL BUTTON
3. FARMHOUSE SINK- KOHLER WHITEHAVEN
4. PENDANT LIGHTS - WARE MEDIUM PENDANTS
5. COUNTERTOPS- SILESTONE QUARTZ - CALACATTA GOLD
6. BACKSPLASH- PASSION 3X8-BLANCO GLOSSY - EXTENDED TO CEILING AT HOOD
7. CABINET HARDWARE- RADIANT PULL
8. PERIMETER CABINETS - TIMBERLAKE SONOMA - PAINTED LINEN (42" WALL CABS)
9. ISLAND CABINETS- TIMBERLAKE SONOMA - MAPLE STAIN LATTE



# APPLIANCES

1



2



3



4



1. HOOD- TIMBERLAKE WOOD HOOD - LINEN PAINTED FINISH
2. GAS COOKTOP - GE - JGP3036SLSS - STAINLESS STEEL
3. COMBO WALL OVEN - JT3800SHSS - STAINLESS STEEL
4. DISHWASHER- GE GDT670SYVFS - STAINLESS STEEL

# POWDER ROOM

1

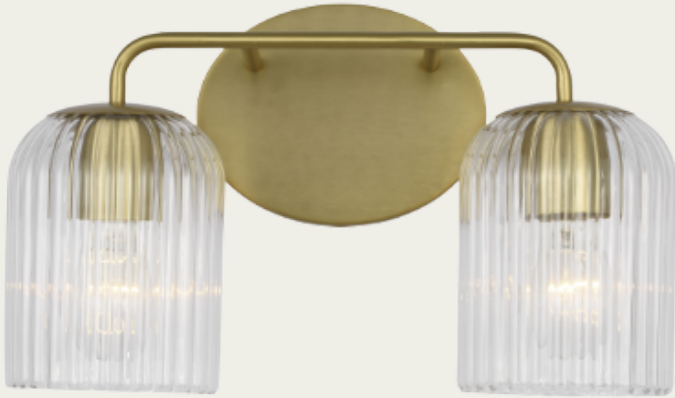

2



3



1. LIGHTING - EISELE 2-LIGHT
2. FAUCET - DELTA - SAYLOR CENTERSET
3. SINK - KOHLER ARCHER PEDESTAL

# LAUNDRY ROOM

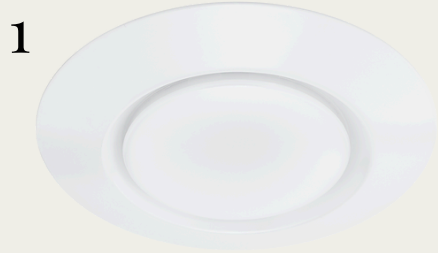

1. LIGHTING - ROUND FLUSH MOUNT (X2)
2. WALL CABINETS- TIMBERLAKE - SONOMA - PAINTED LINEN
3. CABINET HARDWARE- RADIANT PULL
4. TILE FLOOR - DESIGN 9X9 - DIAGRAM



# PRIMARY BATHROOM

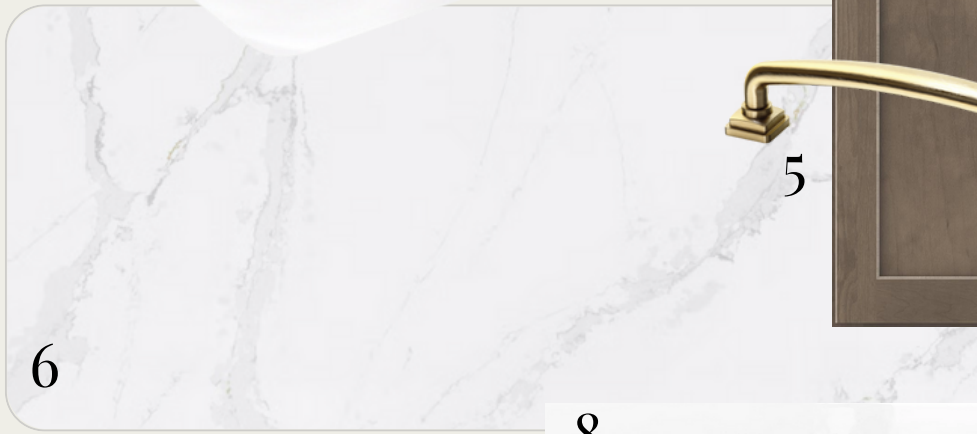

1. FAUCET- DELTA SAYLOR - WIDESPREAD (X2)
2. SINK-RECTANGULAR BASIN (X2)
3. BATHROOM LIGHT FIXTURE - EISELE 3-LIGHT (X2)
4. CABINETS-TIMBERLAKE SONOMA - MAPLE STAIN LATTE
5. HARDWARE- RADIANT PULL
6. COUNTERTOPS- SILESTONE QUARTZ - CALACATTA GOLD
7. BATHROOM FLOOR - JUTE 12X24 - LINEN
8. SHOWER WALLS - CATCH 4X10 - ICE GLOSSY
9. SHOWER FLOOR - IMPACT HERRINGBONE - WHITE
10. SHOWER & TUB FIXTURES - DELTA SAYLOR / HANDHELD SHOWER WAND
11. FREESTANDING TUB - STERLING SPECTACLE
12. SHOWER ENCLOSURE - FRAMELESS

# BATHROOM TWO



1

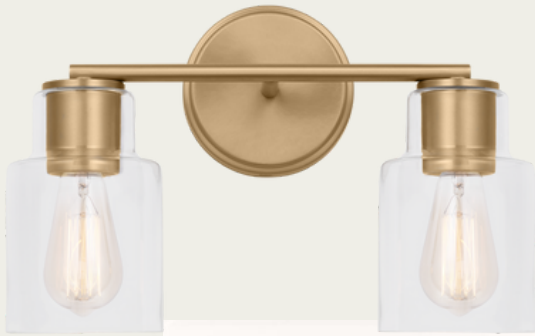

3



2



4



6



5



9



7

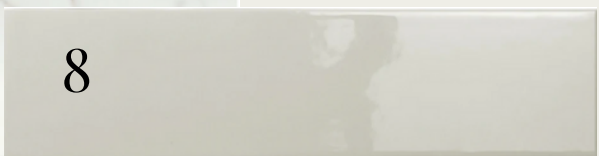

8

10

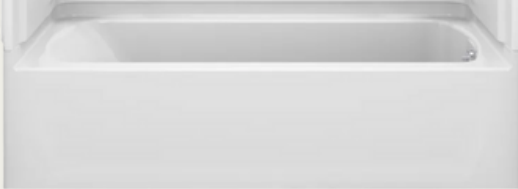

- 1. FAUCET- DELTA SAYLOR - CENTERSET (X2)
- 2. SINK-RECTANGULAR BASIN (X2)
- 3. BATHROOM LIGHTING - SAYWARD 2-LIGHT (X2)
- 4. CABINETS - TIMBERLAKE SONOMA - PAINTED LINEN
- 5. HARDWARE - RADIANT PULL
- 6. COUNTERTOPS - QUARTZ - CARRARA BREVE
- 7. BATHROOM FLOOR - NOBLEZA 12X24 - LUGO MATTE
- 8. TUB WALLS - CATCH 3X12 - FAWN GLOSSY
- 9. TUB/SHOWER FIXTURE - DELTA SAYLOR
- 10. TUB- VIKRELL TUB

# BATHROOM THREE



1



3

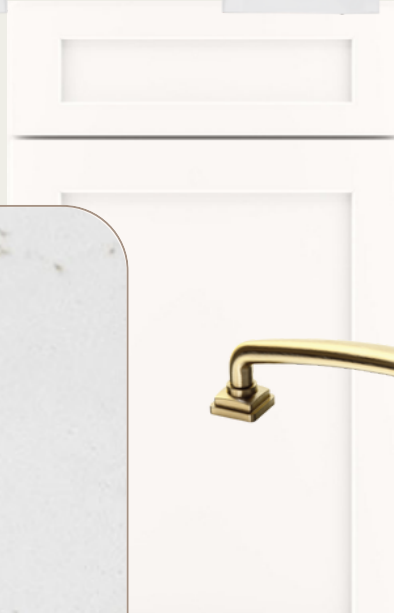

4



5



6



7



8



9



10



11



1. FAUCET- DELTA SAYLOR - CENTERSET (X2)
2. SINK-RECTANGULAR BASIN (X2)
3. BATHROOM LIGHTING - SAYWARD 2-LIGHT (X2)
4. CABINETS - TIMBERLAKE SONOMA - PAINTED LINEN
5. HARDWARE - RADIANT PULL
6. COUNTERTOPS - QUARTZ - CARRARA BREVE
7. BATHROOM FLOOR - NOBLEZA 12X24 - LUGO MATTE
8. SHOWER WALLS - CATCH 4X16 - ICE GLOSSY
9. SHOWER FLOOR - SAVVY 2" HEX - OAT
10. SHOWER FIXTURE - DELTA SAYLOR
11. SHOWER DOOR - FRAMELESS

# TRIMWORK & OTHER SELECTIONS



COFFERED CEILING IN  
FAMILY ROOM

STUDY - FRENCH DOORS  
(PICTURE FOR REFERENCE ONLY)



GARAGE ENTRY DROP-ZONE



REAR 12' WIDE SLIDING  
DOOR  
(PICTURE FOR REFERENCE ONLY)



FINISHES AND FEATURES MAY VARY BY DESIGN - PICTURES FOR REFERENCE ONLY

# TRIMWORK & OTHER SELECTIONS

- OPTIONAL ' REAR PORCH EXTENSION
- OPTIONAL BED 4/BATH 3 LAYOUT
- OPTIONAL (2) ADDITIONAL WINDOWS IN FAMILY ROOM
- ¾ LITE DOORS ON FRONT PORCH
- SOFT-CLOSE CABINET DOORS & DRAWERS IN KITCHEN
- OPTIONAL GOURMET KITCHEN
- OPTIONAL ROUGH-IN FOR FUTURE SINK IN LAUNDRY ROOM
- BASEBOARDS - 1X6 1<sup>ST</sup> & 2<sup>ND</sup> FLOORS
- WINDOW CASINGS - 1X4 LEGS, 1X6 HEADS, 5/4 STOOL, 1X4 APRON
- DOOR CASINGS - 1X4 LEGS, 1X6 HEADS
- 1<sup>ST</sup> FLOOR OPEN STAIR RAILS
- STAIRS - OAK STAINED TREADS AND PAINTED RISERS

FIREPLACE  
VERTICAL SHIPLAP  
SLATE SURROUND  
(PICTURE FOR REFERENCE ONLY)



