

LOT 101
516 AYRHILL LOOP

 SAUSSY BURBANK



*OPTIONAL UPGRADES MAY BE SHOWN ON ARTISTS' RENDERING. SEE AGENT FOR DETAILS.

EASTON-O

EXTERIOR SELECTIONS

1. SIDING - BRACING BLUE (SW6242)
2. TRIM/ACCENTS - PURE WHITE (SW7005)
3. FRONT DOOR- SKY HIGH (SW6504)
4. FOUNDATION - ESSENTIAL GREY (SW6002)
5. SHUTTERS - SIGNAL WHITE (RAL9003)
6. ROOF - MOIRE BLACK

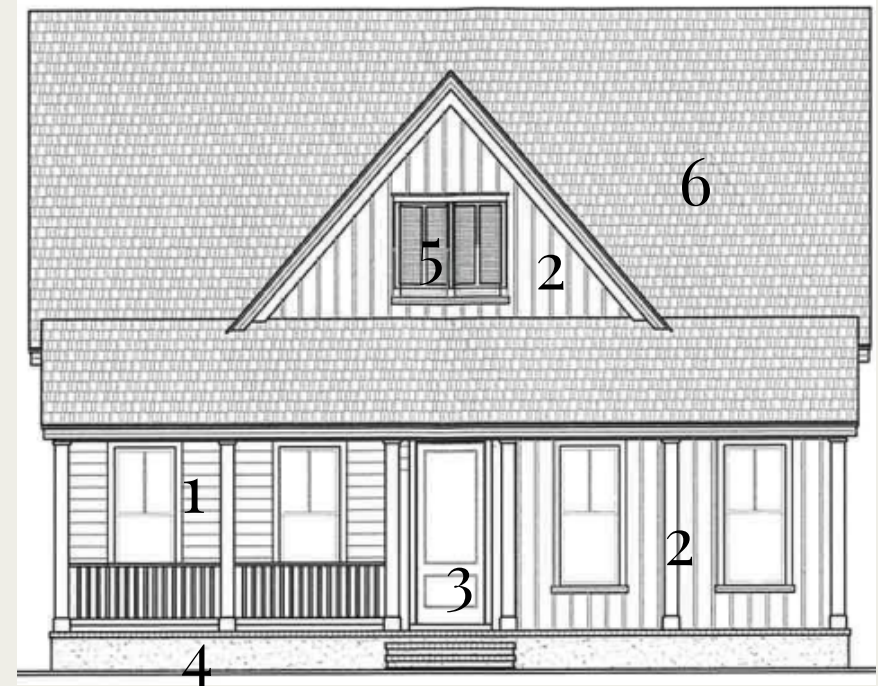
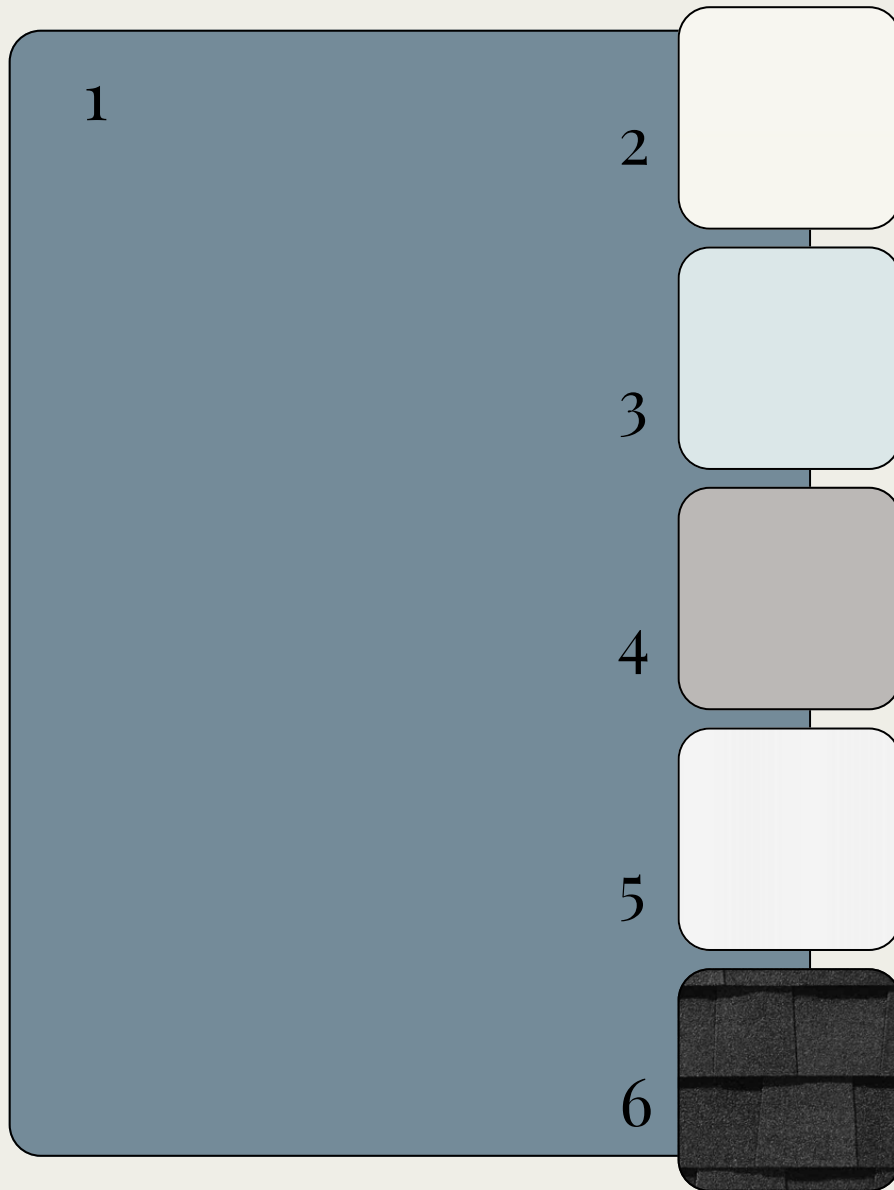

*colors may vary on screen or printed versions

EXTERIOR HARDWARE & LIGHTING

1



2



3



4



5



1. FRONT DOOR HARDWARE - SUTTON - SATIN NICKEL
2. INTERIOR DOOR HARDWARE - STRATUS KNOB - SATIN NICKEL
3. REAR DOOR KEYLESS - TOUCH CENTURY - SATIN NICKEL
4. FRONT, REAR, AND GARAGE ENTRY DOORS - ALCONA MEDIUM WALL LANTERN - BLACK
5. GARAGE DOOR - BARN LIGHT LARGE - BLACK

INTERIOR SELECTIONS

1

2

1. WALL PAINT- SNOWBOUND (SW7004)
2. TRIM PAINT - PURE WHITE (SW7005)
3. FLOORING - ENGINEERED HARDWOOD -MOHAWK - CASPIAN SHORES - SANDALWOOD OAK (1ST FLOOR LIVING AREAS, PRIMARY BED, BED 2, LOFT/HALLWAY)
4. CARPET -MOHAWK - LUSTROUS TONES - ISLAND TAUPE (BED 3&4)
5. LAUNDRY FLOOR TILE - BROOK II - 12X24 - WHITE

3

4

5



INTERIOR LIGHTING



1. FAMILY ROOM - JOVIE 52" FAN - WHITE
2. FOYER - MOFFET STREET MEDIUM LANTERN - BRUSHED NICKEL
3. DINING ROOM - BRIANNA SMALL CHANDELIER - POLISHED NICKEL
4. CLOSETS - ROUND CEILING MOUNT - WHITE
LAUNDRY, BED 2, 3 & 4 - RHETT MEDIUM FLUSH MOUNT - BRUSHED NICKEL
5. PRIMARY BEDROOM - JOVIE 52" LED FAN - WHITE

KITCHEN



1. FAUCET - DELTA ESSA - STAINLESS STEEL
2. SINK - UNDERMOUNT STAINLESS STEEL
3. PENDANT LIGHTS - MONROE CYLINDER PENDANTS - POLISHED NICKEL (X2)
4. COUNTERTOPS- NATURAL STONE - SHADOW STORM
5. BACKSPLASH - ESTASI FLAT 3X12 - WHITE GLOSSY (EXTENDED TO CEILING AT HOOD)
6. CABINET HARDWARE - TEMPO PULL
7. CABINETS - TIMBERLAKE BARNETT - PAINTED LINEN

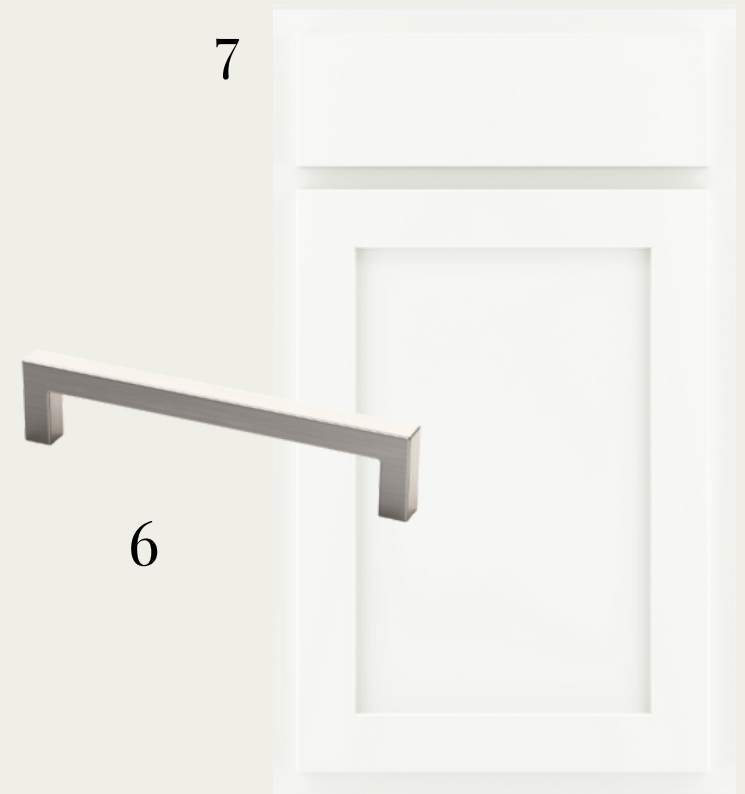
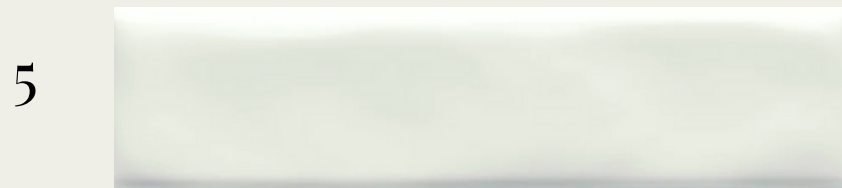

APPLIANCES

1



2



3



4



1. HOOD - GE - UVW8361SLSS - STAINLESS STEEL
2. GAS COOKTOP - GE PROFILE - PGP7036SLSS - STAINLESS STEEL
3. WALL OVEN - GE - JT3800SHSS - STAINLESS STEEL
4. DISHWASHER - GE - GDT635HSRSS - STAINLESS STEEL

PRIMARY BATHROOM



1

2



5



3



4

6



11



10

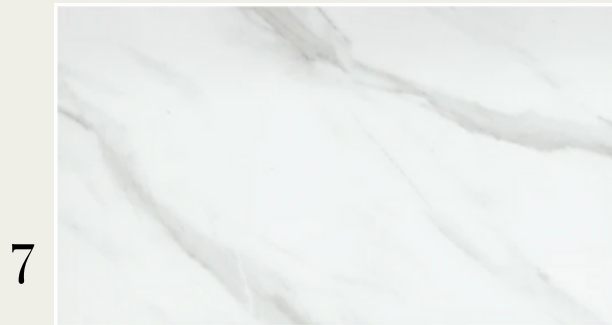

7

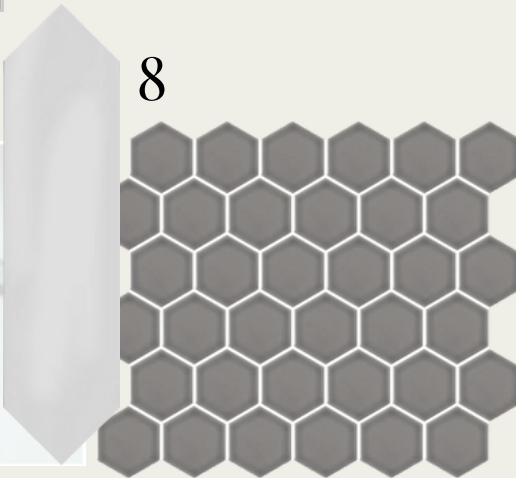

8

9

1. FAUCET- DELTA SAYLOR - STAINLESS - WIDESPREAD (X2)
2. SINK-RECTANGULAR BASIN (X2)
3. BATHROOM LIGHTING - LANDO 2-LIGHT (X2) - BRUSHED STEEL
4. CABINETS-TIMBERLAKE BARNETT - PAINTED LINEN
5. COUNTERTOPS- NATURAL STONE - SHADOW STORM
6. HARDWARE- TEMPO PULL
7. BATHROOM FLOOR- NOBLEZA 12X24 - ASTORGA MATTE
8. SHOWER WALLS - CRAFT II PICKET - WHITE GLOSSY (TO CEILING)
9. SHOWER FLOOR - SAVVY 2" HEXAGON - SILVER
10. SHOWER FIXTURE - DELTA SAYLOR
11. SHOWER ENCLOSURE - FRAMELESS



BATHROOM TWO



1



3



2



4

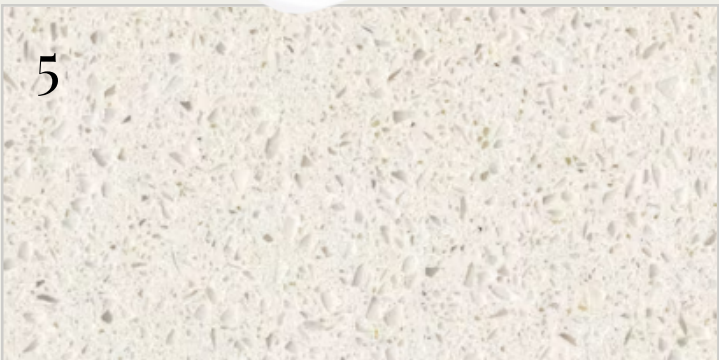

5



10



7

8

9

- 1. FAUCET- DELTA SAYLOR - SINGLE
- 2. SINK - RECTANGULAR BASIN
- 3. BATHROOM LIGHTING - EMILE MEDIUM VANITY LIGHT - BRUSHED STEEL
- 4. CABINETS - TIMBERLAKE BARNETT - PAINTED STONE
- 5. COUNTERTOPS- QUARTZ - BLANCO MAPLE
- 6. HARDWARE - TEMPO PULL
- 7. BATHROOM FLOOR - SOLARA 12X24 - CABRIO
- 8. SHOWER WALLS - CATCH 3X12 - GREY GLOSSY
- 9. SHOWER FLOOR - SAVVY - PENNIES - WHITE
- 10. SHOWER FIXTURE - DELTA SAYLOR
- 11. SEMI-FRAMELESS SLIDING SHOWER DOOR



11

BATHROOM THREE

1



3



2



4



6



5



7

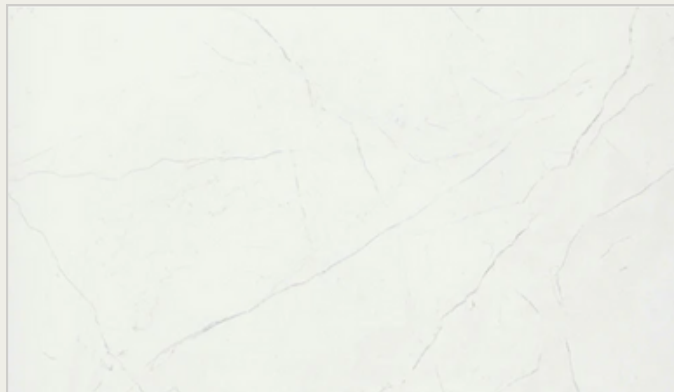

8



9



1. FAUCET- DELTA SAYLOR - SINGLE
2. SINK - RECTANGULAR BASIN
3. BATHROOM LIGHTING - EMILE MEDIUM VANITY LIGHT - BRUSHED STEEL
4. CABINETS - TIMBERLAKE BARNETT - PAINTED STONE
5. COUNTERTOPS- QUARTZ - BLANCO MAPLE
6. HARDWARE - TEMPO PULL
7. BATHROOM FLOOR - SOLARA 12X24 - CABRIO
8. TUB/SHOWER FIXTURE - DELTA SAYLOR
9. VIKRELL TUB/SHOWER COMBINATION - WHITE

POWDER ROOM

1



2



1. FAUCET- DELTA SAYLOR - SINGLE
2. BATHROOM LIGHTING - LANDO 2-LIGHT - BRUSHED STEEL
3. PEDESTAL SINK - SACRAMENTO - WHITE

3



TRIMWORK & OTHER SELECTIONS

- BASEBOARDS - OPTIONAL 1X6
- WINDOW CASINGS - OPTIONAL
1X4 LEGS, 1X6 HEADS W/ SILL

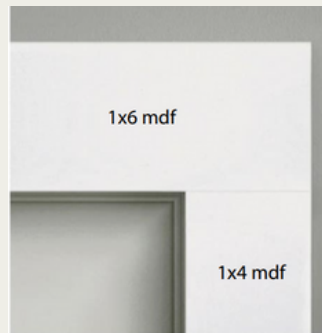

- DOOR CASINGS - STANDARD
1X4 LEGS, 1X6 HEADS
- GOURMET KITCHEN LAYOUT
- STAIRS - STAINED OAK TREADS
W/ PAINTED RISERS

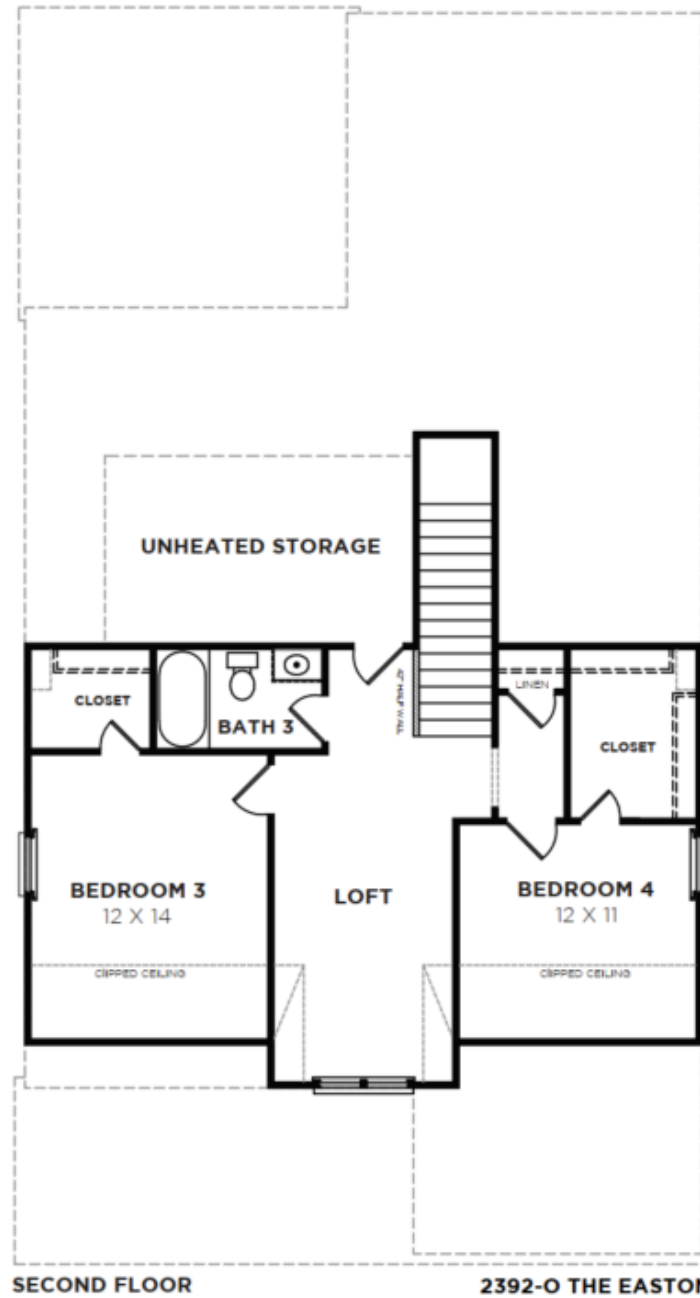
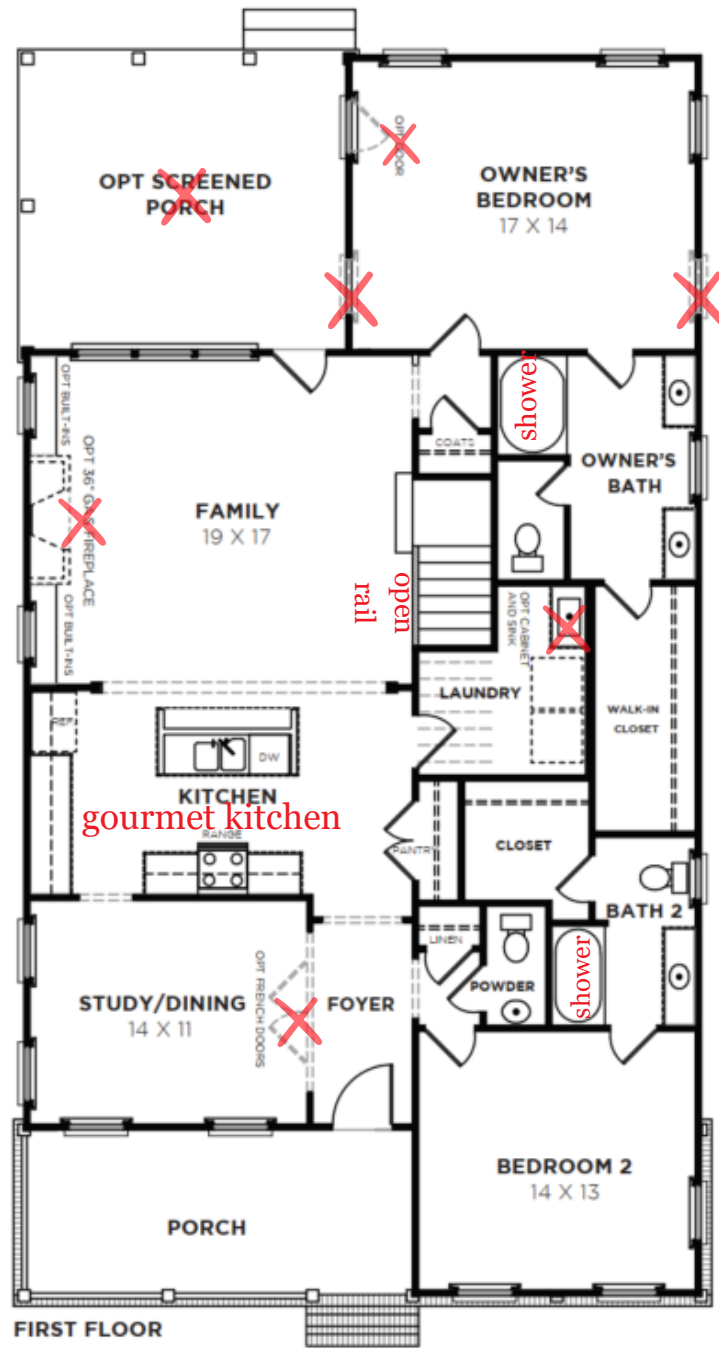

2392-O THE EASTON
05/01/24